

NOKIA

Elevate your Wi-Fi performance with Corteca AI

Justin Doucette
November 2025



Get to Fast Faster 2025

Experience is everything

Don't let the home network ruin it

1.4B

Broadband connected homes globally

21B

Wi-Fi devices will be actively in use this year

57%

Global internet traffic is over Wi-Fi

95%

In-home connectivity is over Wi-Fi

1 Gbps

Gigabit is common, growing to multi-gigabit

40%+

Broadband households experience issues

70%

Wi-Fi related customer service support calls

Nokia Corteca

Smarter broadband
for a better experience

6M+ devices managed

1.6M+ 3rd party APs

110+ Corteca Cloud
customers



Corteca's three management use cases for operators



Wi-Fi management

- Real-time monitoring
- Proactive troubleshooting
- Wi-Fi optimization
- Performance monitoring



Device management

- Configuration management
- Software lifecycle management
- Remote diagnostics
- 3rd-party device support



Application management

- Configuration management
- Software lifecycle management
- Troubleshooting

Corteca supports open broadband standards



Application lifecycle management



Container formats and runtime environment



Device management from the cloud

Operator
Managed
Wi-Fi
Reference
Architecture

USP/TR-369

TR-181

USP Agent
(OB-USP-A)



Mesh networking and Wi-Fi certification

EasyMesh

Data Elements

Wi-Fi
certification



Corteca supports private and public cloud



Google Cloud



OPENSIFT

Let's talk about continued optimization...



AI



OPEX

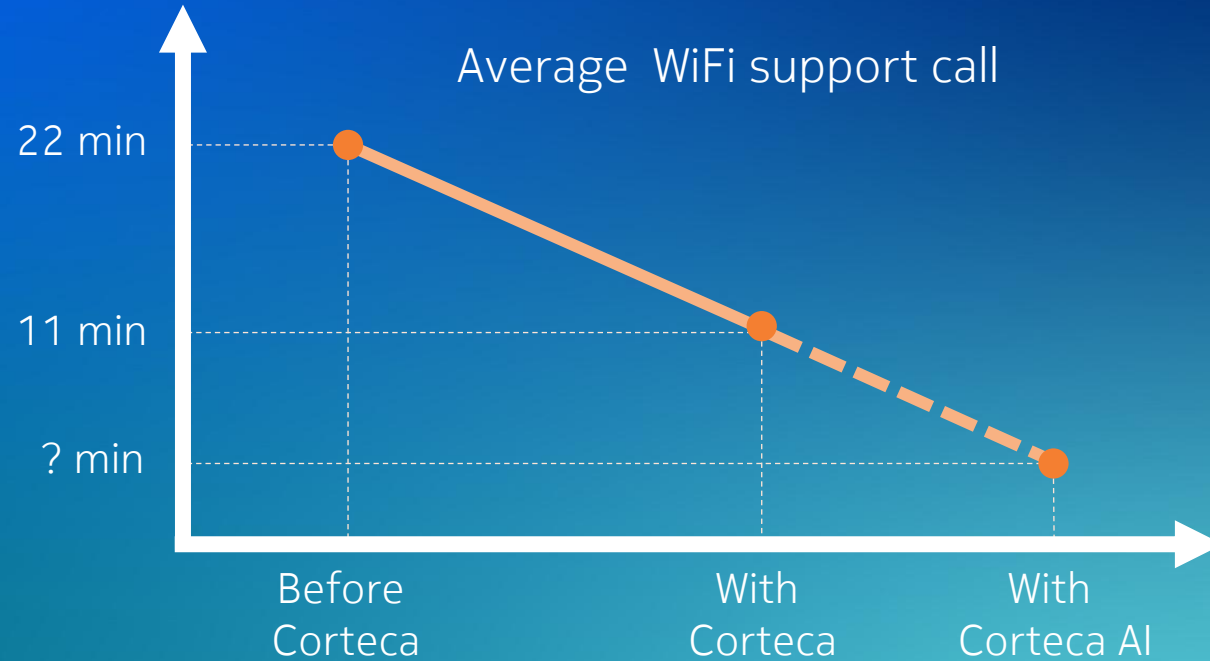



193B

The number of unique WiFi related data points gathered by Corteca every 24 hours

Corteca AI will use data, algorithms, model optimization, and compute to provide users with...

Adaptive WiFi intelligence.

- Proactive troubleshooting
- Improved band steering
- Improved channel steering
- Backhaul optimization
- Predictive care
- Symptom detection
- Anomaly detection
- Power savings
- Data correlation
- Custom recommendations
- Automated alarms
- Real-time reporting
- Real-time visualization
- Target marketing

Corteca AI Strategy & Vision

01

Agentic AI Troubleshooter

Reduce time to resolve issues by identifying the problem, automating complex data analysis, and providing tailored solutions to novice call center agents

02

Extend to the End User

Mobile app chatbot that guides the user to provide relevant information about the issue, make a summary, and share it with the care agent before the call

03

Autonomous WiFi Optimization

Multiple AI agents working together both in the cloud and on the edge to provide optimal Wi-Fi performance tailored for every environment, in real-time

01 Agentic AI Troubleshooter

A digital expert...

An agentic AI-based problem finder that processes Care Agent requests and runs network data analysis to suggest the relevant actions to take to solve the End-user problem

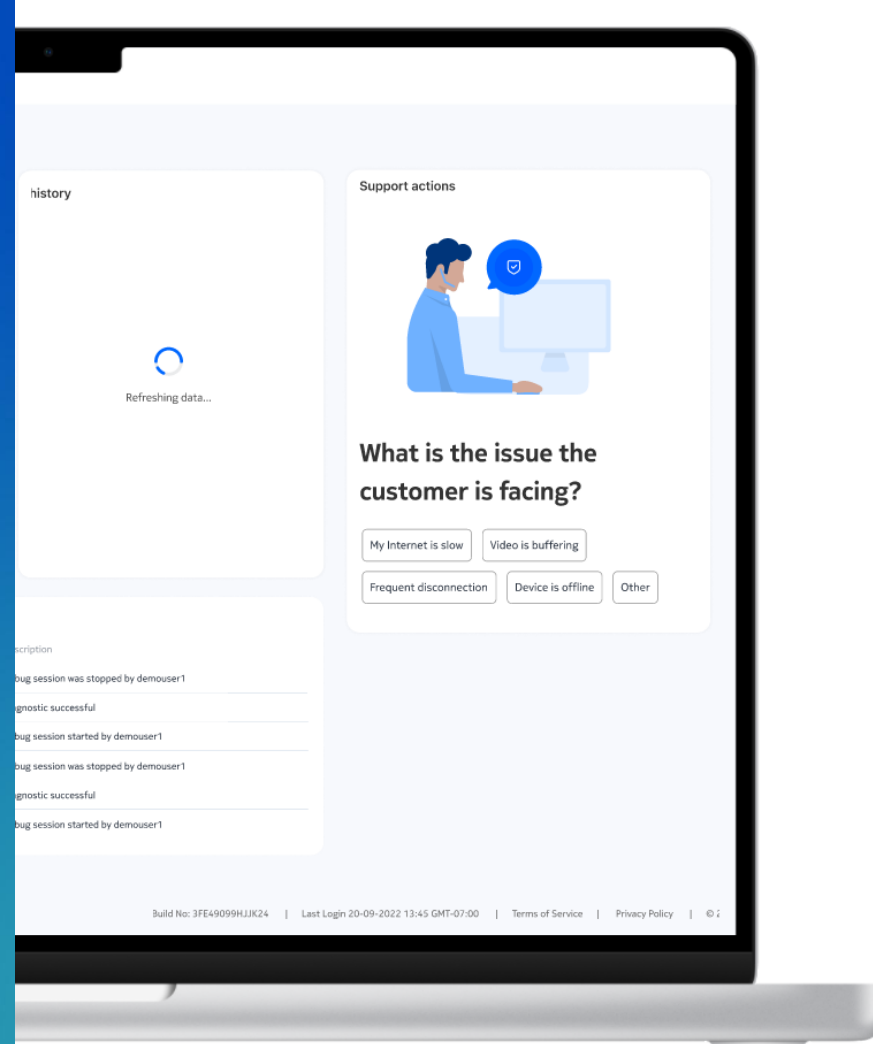

01 Agentic AI Troubleshooter

Support actions



What is the issue the customer is facing?

My Internet is slow Video is buffering

Frequent disconnection Device is offline Other



Support actions

AI Analysis in progress

In the meantime you can provide more context and additional information

Add additional information 



Support actions

The user complains about frequent disconnections of the Smart TV in the bedroom.

The issue appears to stem from low signal strength for the Beacon named 'Bedroom,' indicating that the problem may be due to the placement of the unit.

Suggested Actions

Suggest moving the Beacon closer or add a new one
Since this reason

Reboot Wi-Fi point
Since this reason >

Asks follow-up questions 

Reduce time = Reduced costs

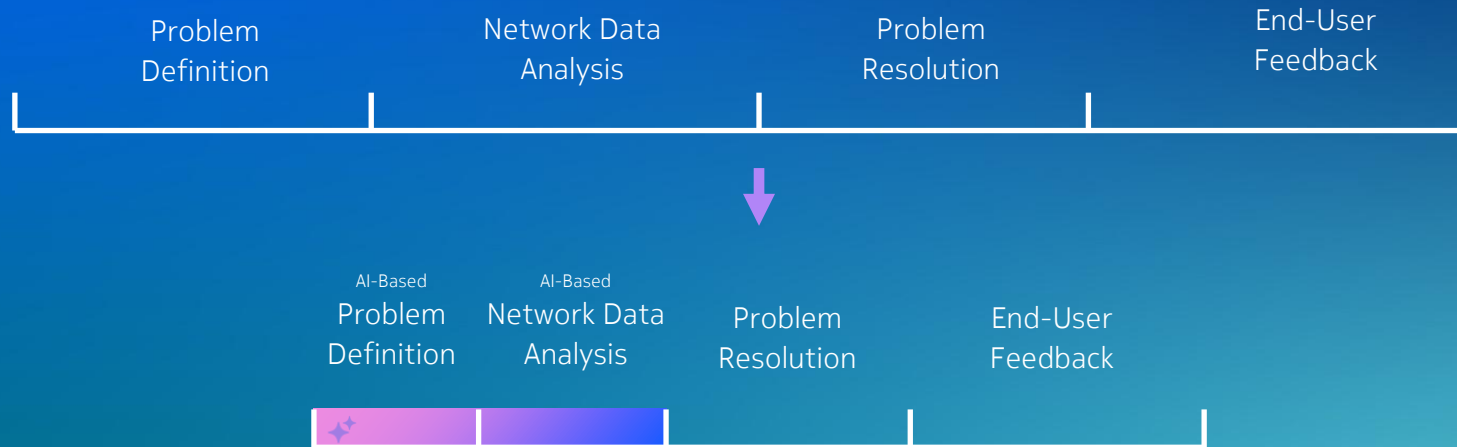

02 Extend to End User

Empower the end user

In-app chatbot that guides the user to provide relevant information about the issue, make a summary, and share it with the care agent before the call

- Guides the End-User to explain the issue in simple terms
- Collects key information automatically
- Detects missing details and prompts the user to add them
- Maintains memory across sessions
- Save conversations for future reuse

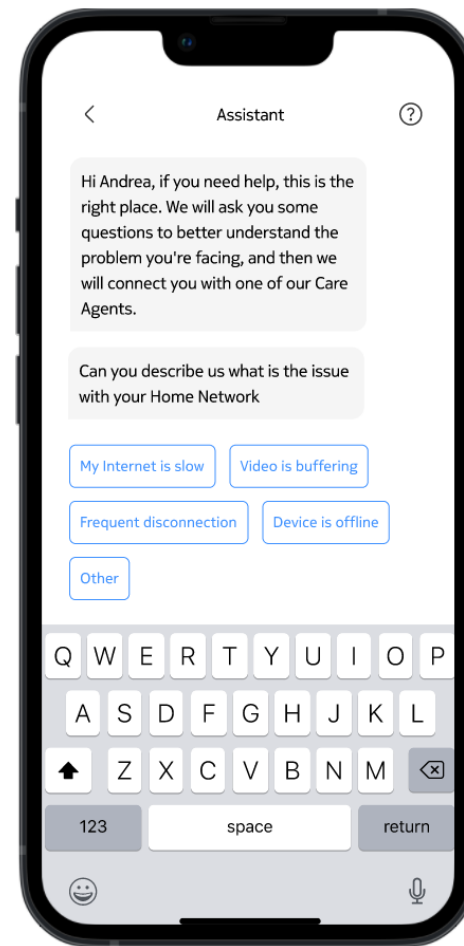

02

Extend to End User

Empower the End User

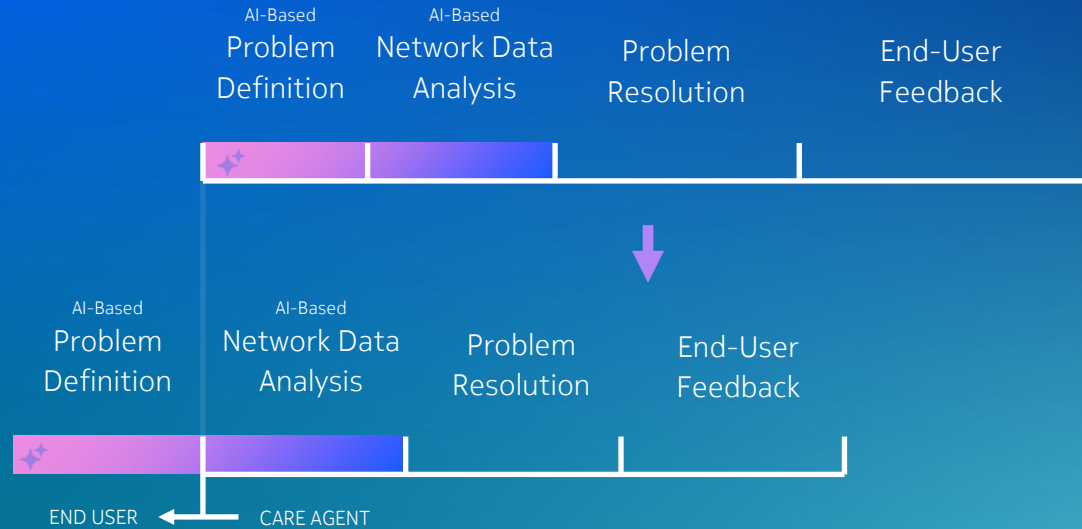

03

Autonomous Wi-Fi Optimization

Fully Autonomous Wi-Fi networks:
Issues are solved before end users
even become aware of them.

- Continuous and precise measurement of QoE on a per-application basis
- Continuous Optimization of each application's QoE
- Continuous RF interference measurement and channel optimization
- Automatic band steering and AP steering
- Automatic anomaly detection and anomaly mitigation

Making users aware of the delivered value will reduce churn.

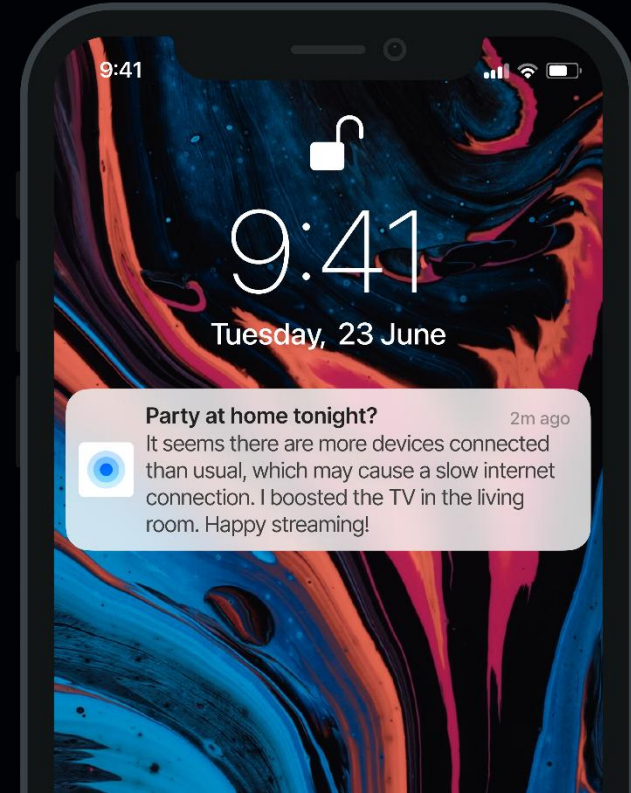

03 Autonomous Wi-Fi Optimization

Autonomous Networks

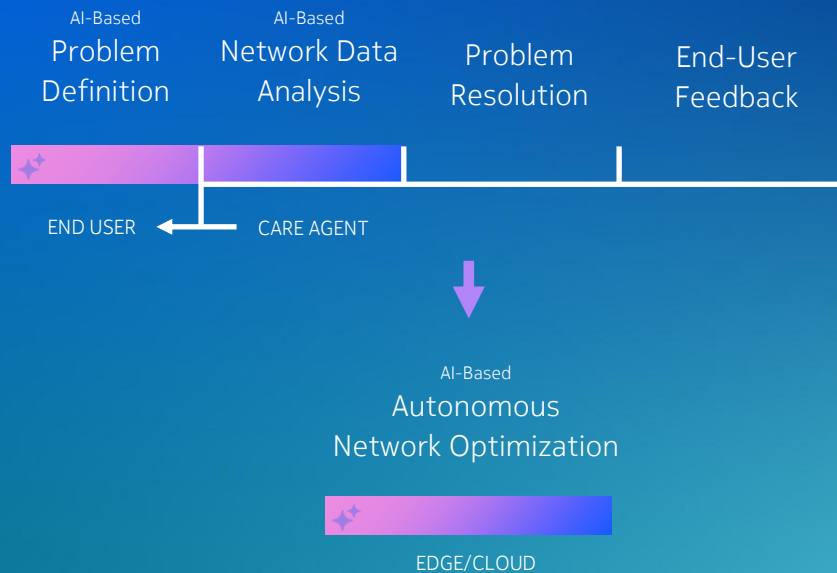

In closing...



Wi-Fi

“The Killer App”



Corteca

Managed
Wi-Fi



AI

Adaptive Wi-Fi
intelligence

NOKIA

Copyright and confidentiality

The contents of this document are proprietary and confidential property of Nokia. This document is provided subject to confidentiality obligations of the applicable agreement(s).

This document is intended for use by Nokia's customers and collaborators only for the purpose for which this document is submitted by Nokia. No part of this document may be reproduced or made available to the public or to any third party in any form or means without the prior written permission of Nokia. This document is to be used by properly trained professional personnel. Any use of the contents in this document is limited strictly to the use(s) specifically created in the applicable agreement(s) under which the document is submitted. The user of this document may voluntarily provide suggestions, comments or other feedback to Nokia in respect of the contents of this document ("Feedback").

Such Feedback may be used in Nokia products and related specifications or other documentation. Accordingly, if the user of this document gives Nokia Feedback on the contents of this document, Nokia may freely use, disclose, reproduce, license, distribute and otherwise commercialize the feedback in any Nokia product, technology, service, specification or other documentation.

Nokia operates a policy of ongoing development. Nokia reserves the right to make changes and improvements to any of the products and/or services described in this document or withdraw this document at any time without prior notice.

The contents of this document are provided "as is". Except as required by applicable law, no warranties of any kind, either express or implied, including, but not limited to, the implied warranties of merchantability and fitness for a particular

purpose, are made in relation to the accuracy, reliability or contents of this document. NOKIA SHALL NOT BE RESPONSIBLE IN ANY EVENT FOR ERRORS IN THIS DOCUMENT or for any loss of data or income or any special, incidental, consequential, indirect or direct damages howsoever caused, that might arise from the use of this document or any contents of this document.

This document and the product(s) it describes are protected by copyright according to the applicable laws.

Nokia is a registered trademark of Nokia Corporation. Other product and company names mentioned herein may be trademarks or trade names of their respective owners.